



User Guide

MA-101C Cabled Megaphone



! IMPORTANT SAFETY INSTRUCTIONS !

1. Read these instructions.
2. Keep these instructions.
3. Heed all warnings.
4. Follow all instructions.
5. Do not use this apparatus near water.
6. Clean only with a dry cloth.
7. Do not block any ventilation openings. Install in accordance with the manufacturer's instructions.
8. Do not install near any heat sources such as radiators, heat registers, stoves, or other apparatus (including amplifiers) that produce heat.
9. Do not defeat the safety purpose of the polarised or ground plug: A polarised plug has two blades with one wider than the other. The wide blade is provided for your safety. When the provided plug does not fit into your outlet, consult an electrician for replacement of the obsolete outlet.
10. Protect the power cord from being walked on or pinched particularly at plug, convenience receptacles, and the point where they exit from the apparatus.
11. Only use attachments/accessories specified by the manufacturer.
12. Use only with a cart, stand, tripod, bracket, or table specified by the manufacturer, or sold with the apparatus. When a cart is used, use caution when moving the cart/apparatus combination to avoid injury from tip-over.
13. Unplug this apparatus during lightning storms or when unused for long periods of time.
14. Refer all servicing to qualified service personnel. Servicing is required when the apparatus has been damaged in any way, such as power-supply cord or plug is damaged, liquid has been spilled or objects have fallen into the apparatus, the apparatus has been exposed to rain or moisture, does not operate normally, or has been dropped.
15. To reduce the risk of fire or electric shock, do not expose this apparatus to rain or moisture.
16. Apparatus should not be exposed to dripping or splashing and no objects filled with liquids, should be placed on the apparatus.
17. Use only with the battery which specified by manufacturer.
18. The power supply cord set is to be the main disconnected device.



WARNING

1. FOR OUTDOOR USE:



To reduce the risk of fire or electric shock, do not expose this apparatus to rain or moisture.

2. UNDER WET LOCATION:

Apparatus should not be exposed to dripping or splashing and no objects filled with liquids, such as vases should be placed on the apparatus.

3. SERVICE INSTRUCTIONS:

CAUTION - These servicing instructions are for use by qualified service personnel only. To reduce the risk of electric shock, do not perform any servicing other than that contained in the operating instructions unless you are qualified to do so.

	This symbol indicates that dangerous voltage constituting a risk of electric shock is present within this unit.
	This symbol indicates that there are important operating and maintenance instructions in the literature accompanying this unit.

FC & IC - ID

THIS DEVICE COMPLIES WITH PART15 OF THE FCC RULES AND RSS-123 ISSUE2 OF CANADA. OPERATION IS SUBJECT TO THE FOLLOWING TWO CONDITIONS:

(1) This device may not cause interference.

(2) This device must accept any interference, including interference that may cause undesired operation of the device. This equipment complies with FCC RF radiation exposure limits set forth for an uncontrolled environment.



Dispose of any unusable devices or batteries responsibly and in accordance with any applicable regulations.

Disposing of used batteries with domestic waste is to be avoided!

Batteries / NiCad cells often contain heavy metals such as cadmium(Cd), mercury(Hg) and lead(Pb) that makes them unsuitable for disposal with domestic waste. You may return spent batteries/ accumulators free of charge to recycling centres or anywhere else batteries/accumulators are sold.

By doing so, you contribute to the conservation of our environment!



"This product can only be used at the area that the altitude is lower than 2000m for safety purpose."



"This product can be used in non-tropical locations only for safety purpose."

Part Names

MA-101C

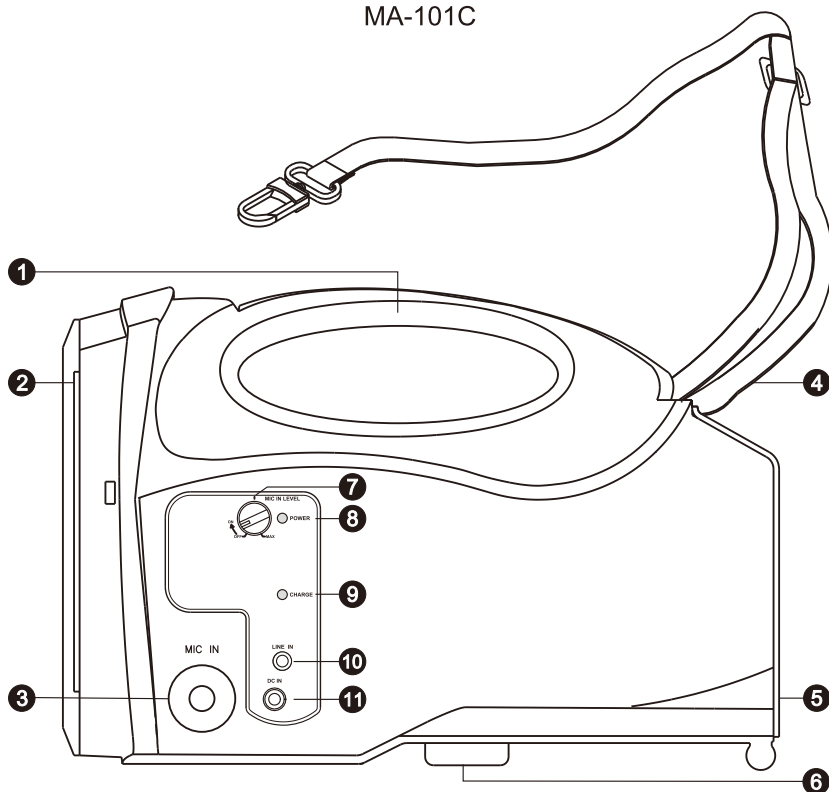

- | | |
|--|--|
| ❶ Molded Carry Handle | ❹ Microphone Stand Adapter |
| ❷ Speaker | ❺ Power Switch / Wired Mic Volume Control |
| ❸ 6.3 mm Wired Dynamic Mic Input Jack | ❻ Power on Indicator Light |
| ❹ Adjustable Shoulder Strap | ❼ Battery Charging Indicator |
| ❺ Rechargeable Battery Compartment Cover | ❽ 3.5 mm Line Input Connector |
| | ❾ DC Power Input Jack: the center electrode connects positive voltage. |

Operating Instructions

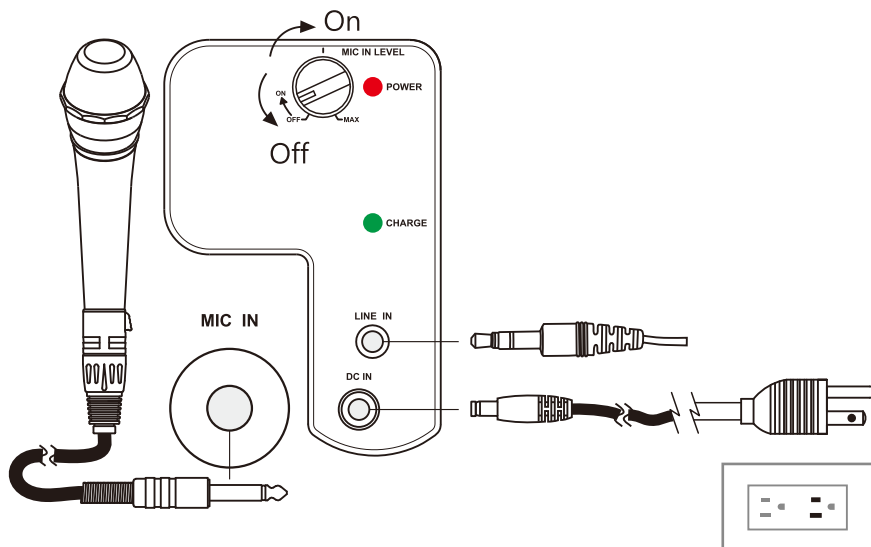

1. Operating Wired Microphone

- Plug a 6.3 mm wired dynamic microphone into Mic Input Jack ③ .
- Turn on Power Switch ⑦ , Power on indicator light glows red ⑧ , and turn on wired microphone volume control.
- Adjust Wired Mic Volume Control ⑦ for desired volume level.

2. Auxiliary Input (Line Input)

Connect a line-level audio source into the 3.5 mm line input jack ⑩ and power on ⑦ . Desired volume level is adjusted from the audio source.

3. System Setup Scenarios

MA-101 system can be hand or shoulder carried, on an elevated surface or installed in a tripod microphone stand.

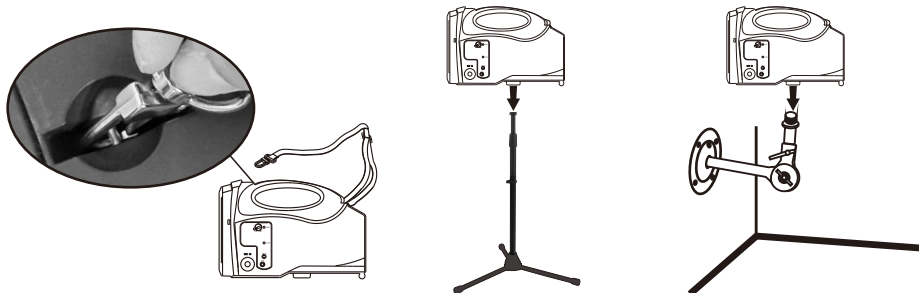

Operating the Rechargeable Battery

1. Operating Instructions:

- We recommend fully charging before first using the system.
- Plug into the DC Power Input Jack ❶ and plug the other end into a live electrical outlet.
- Once plugged, the Battery Charge Indicator ❸ starts blinking to denote charging in progress. Over-discharged battery may take few minutes for indicator to start blinking. No blinking indicates the rechargeable battery has reached the end of its usable life.
- A still red LED indicates insufficient power, recharging is required. A blinking green LED indicates charging in progress. A still green LED indicates fully charged.

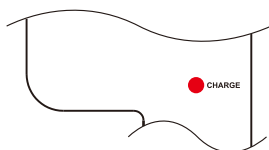

insufficient power

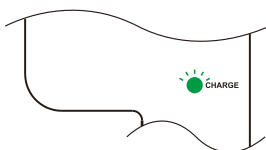

charging in progress

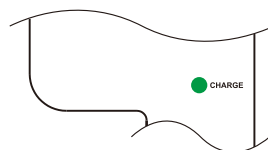

fully charged

- When not in use, the battery will slowly self-discharge. If system will not be used for an extended period of time, it is advised to fully charge before storing. We also recommend to charge the system every three months when not used.
- This system has a dual-step automatic power shut-off function. Power supply will automatically shut-off once LED indicator glows red for an extended of time to prevent possible damage. Plug in to recharge the system immediately from excessive self-discharged.
- If you find that the operation time of system becomes noticeably decreased, even after fully charging, the battery should be replaced.
- With proper care and charging, it is unlikely to replace the rechargeable battery for some time. Contact MIPRO customer service or your local distributor for a single 14.8V replacement rechargeable battery.

2. Replacing the Rechargeable Battery

- (1) Turn off the system. Open the battery compartment by pressing down on the two tabs at the top of the battery compartment. The door will hinge open.



- (2) The battery is “spring loaded” behind an interior steel plate. Remove the interior steel plate by sliding it upwards and battery.

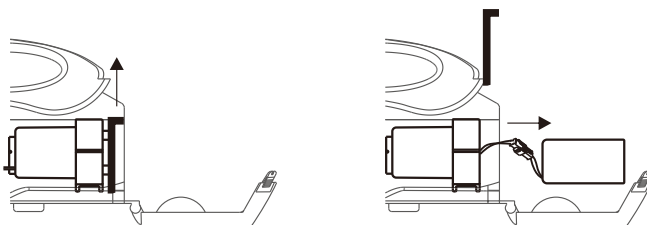

- (3) Press and release the tabs to disconnect the rechargeable battery pack from the connecting cable.

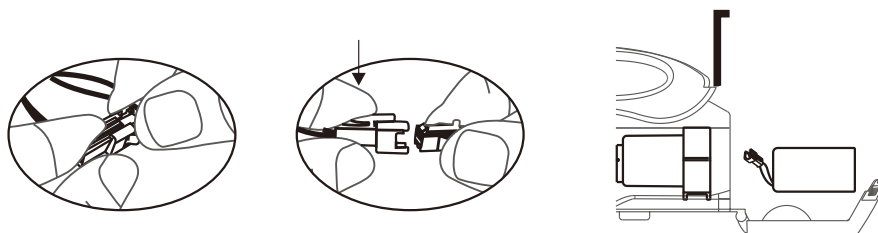

- (4) Connect a new rechargeable battery pack to the connecting cable. Slide the battery pack back into the slot carefully. Insert the interior steel plate downwards.

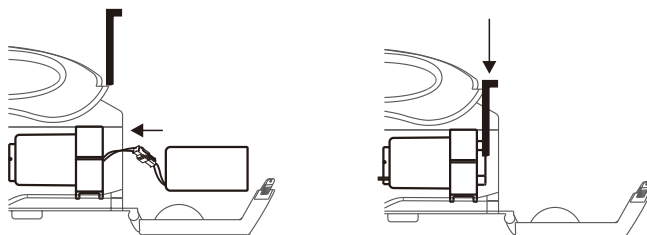

- (5) Close the battery compartment door. Lift up on the two tabs until they “click” into place.

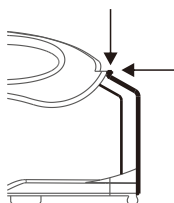

Connection Scenarios

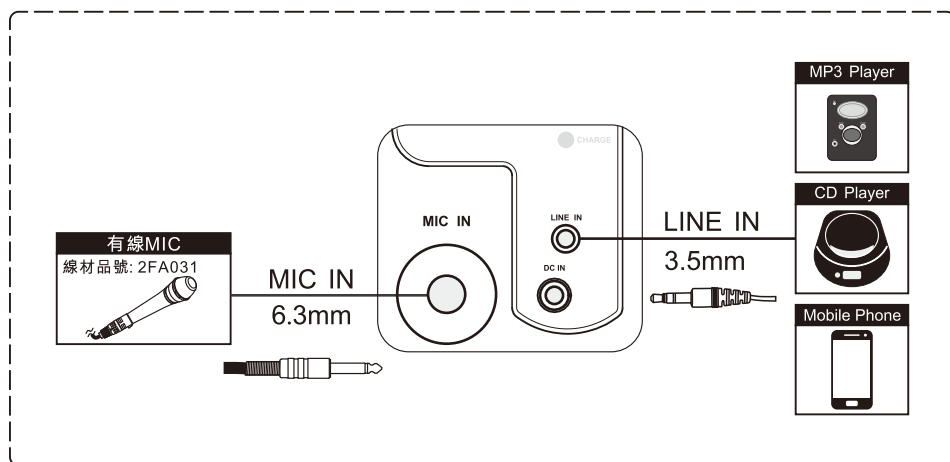

MM-107 Specifications

1. Type: Dynamic
2. Directionality: Hypercardioid
3. Capsule Installation: Fixed
4. Switch: 2-level switch
5. Frequency Response: 50Hz~18kHz
6. Output Impedance: 400Ω
7. Housing: Black zinc alloy



MM-107 See Below Illustrations

Circuit

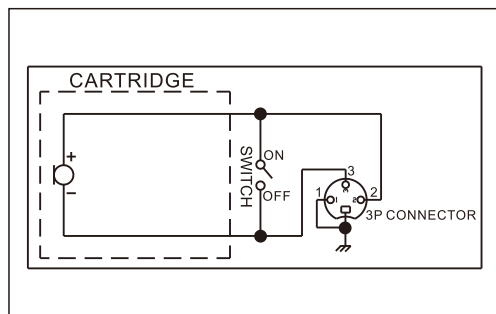

Typical Polar Patterns

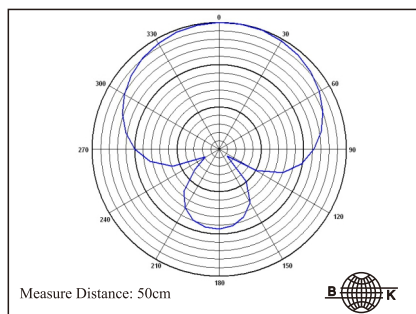

Typical Frequency Response

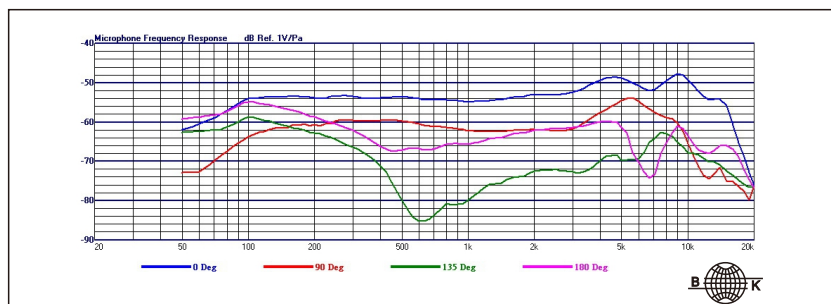

Notes

1. Design and specifications are subject to change without prior notice. Refer to the actual product in the event of product discrepancy.
2. Frequency range, output power and maximum deviation adhere to local telecom regulations.
3. Spraying alcohol directly onto the condenser capsule module will cause severe damage and invalidate the warranty.

Troubleshooting

1. Product won't turn on
 - Check if the battery is low.
 - Ensure the power cord is properly connected.
2. Low volume or no sound
 - Check if the volume is turned down or at minimum.
 - Ensure the wired microphone is securely connected.
3. Battery won't charge
 - Verify that the charger is working.
 - Check if the charging cable is properly connected.

MIPRO Electronics Co., Ltd

Headquarters: No. 814, Beigang Rd., Chiayi City 600079, Taiwan

Tel : +886-5-238-0809

Fax : +886-5-238-0803

www.mipro.com.tw

mipro@mipro.com.tw



2CE699A

All rights reserved. Do not copy or forward without prior approvals of MIPRO.
Specifications and design subject to change without notice. YM 024/09