

ACT-580TR

5 GHz Digital Recordable Transmitter

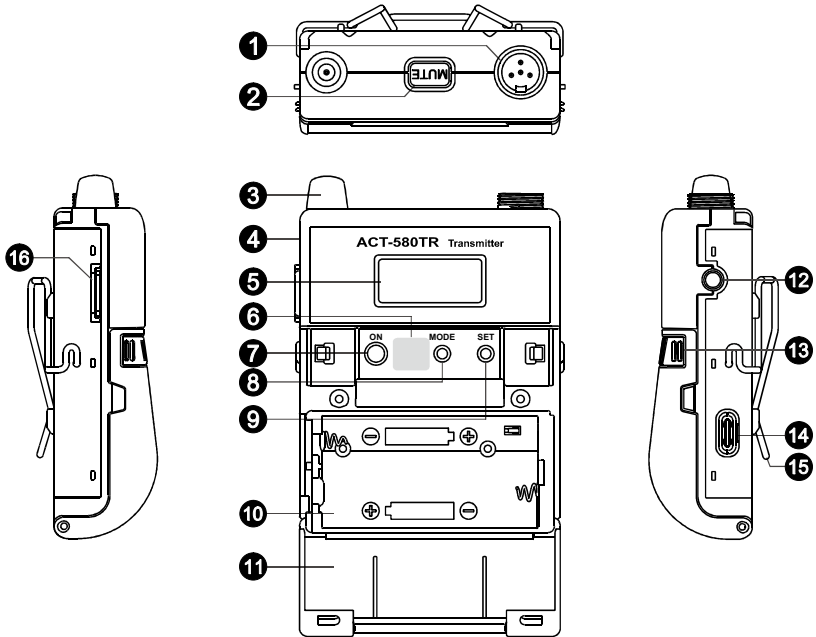

Parts Name



❶ 4-Pin Microphone Input Jack

❷ Mute Button

❸ Transmitting Antenna

❹ Housing

❺ LCD Screen

❻ ACT Sync Window

❼ Power Button

❽ MODE Button

❾ SET Button

❿ Battery Compartment

⓫ Battery Cover

⓬ Remote Mute Control Socket

⓭ Battery Cover Latch

⓮ USB Type-C Charging Port and Indicator Light

⓯ Belt Clip

⓰ SD Card Slot

Audio Input Operation

- Before powering on, please complete the signal source connections to avoid noise.
- Align the latch on the output connector with the groove inside the input jack.
- Insert the connector into the jack and rotate the locking ring clockwise to ensure the connector is securely fastened, as shown.

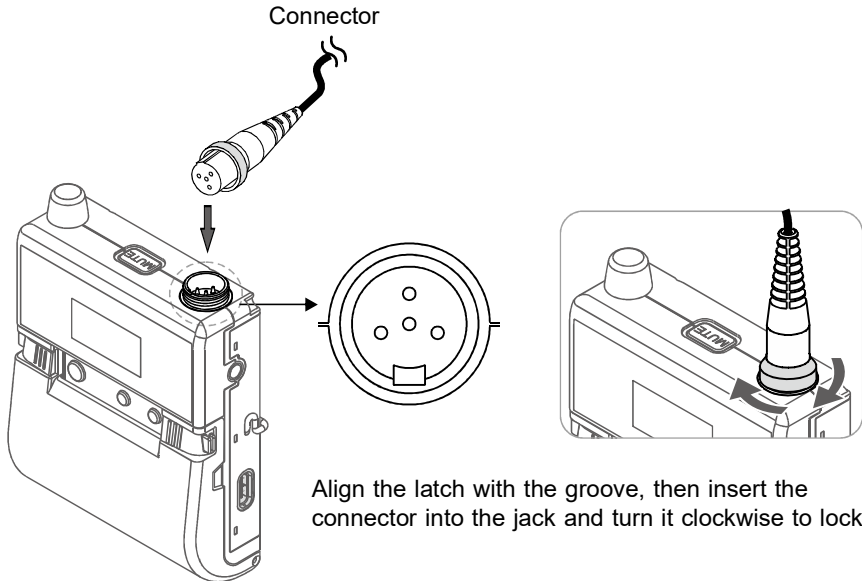

Battery Installation and Charging

■ Open the Battery Cover

Press the Battery Cover Latches inward on both sides and simultaneously lift the cover downward to open.

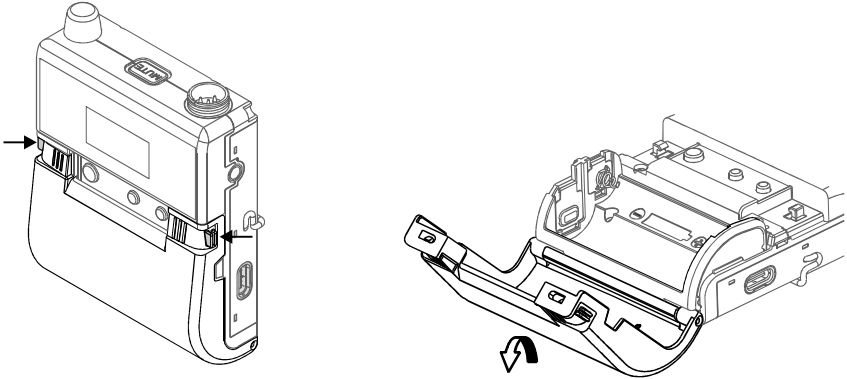

■ Installing AA Batteries

Insert one AA battery into the lower slot with the positive (+) pole facing left, and another into the upper slot with the negative (-) pole facing left.

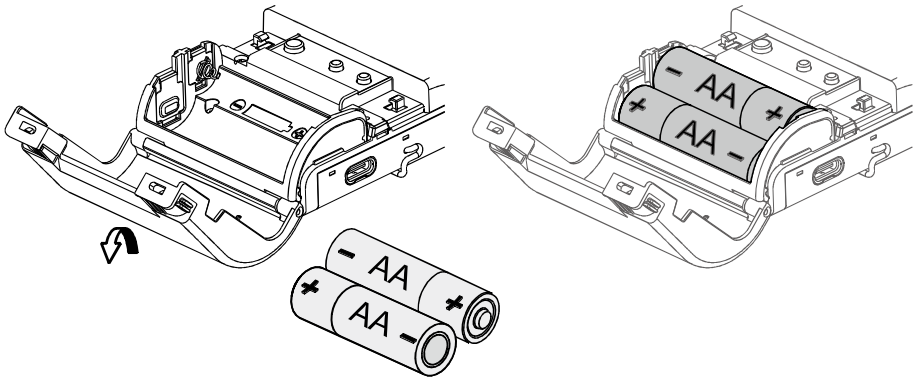

■ Installing 18500 Rechargeable Lithium Battery

Insert the battery into the lower slot of the battery holder with the positive (+) pole facing left (as shown).

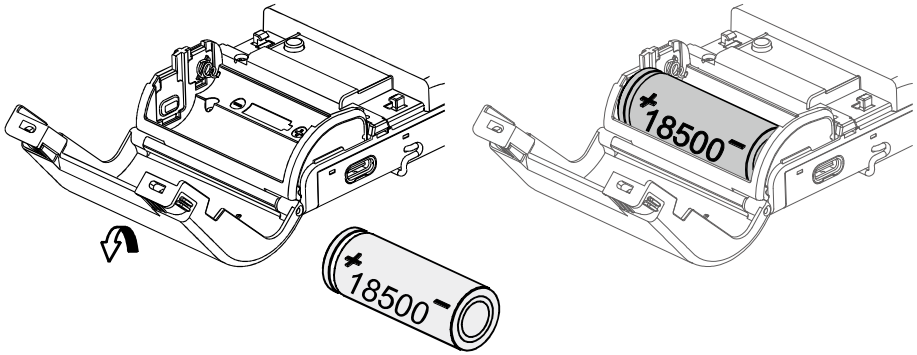

■ USB Type-C Charging

- Plug USB Type-C charging cable.
- When charging, the indicator light will display red.
- Once charging is complete, the indicator light will display green.

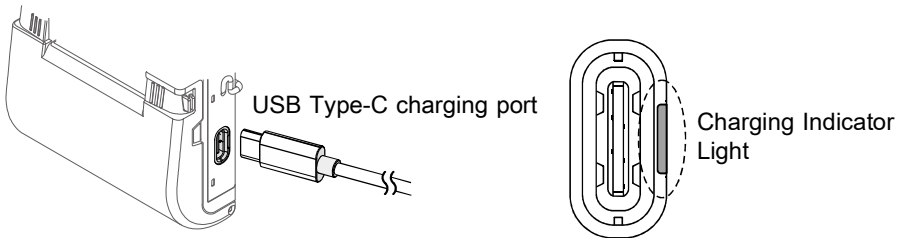

Cautions

- Turn off the transmitter power before inserting batteries or charging.
- Do not mix different types of batteries, such as 1.8V AA lithium batteries with 14500 lithium batteries or standard AA disposable batteries. Any resulting damage will not be covered under warranty.
- Rechargeable batteries are limited to 18500 lithium batteries. Ensure the battery polarity is correct before charging.
- Avoid removing rechargeable batteries during charging. It is recommended to disconnect the charger or charging dock before removing the battery.
- If the charging indicator does not light up, check whether the battery polarity is correct and reinsert the battery.
- If the transmitter cannot be powered on after inserting the batteries, verify that the battery is installed correctly and has sufficient charge. Reinstall and try again.
- Remove the batteries if the transmitter will not be used for an extended period to prevent battery depletion.

Operation Instructions

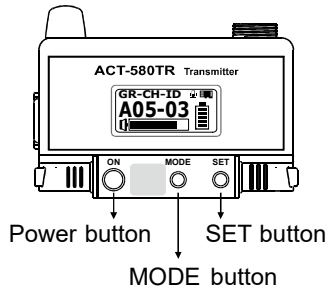

■ Power On/Off

- Press and hold the power button to turn on or off. The LCD screen lights up when powered on.
- After powering off, the LCD screen will display "OFF..." and then turn off automatically.

■ MODE Setting

Press MODE button to select functions.

■ Parameter Setting

Press SET button, and parameter starts to flash. Press SET button again to change parameter.

■ Belt Clip

Standard

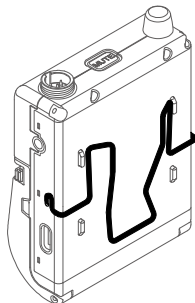

Reverse

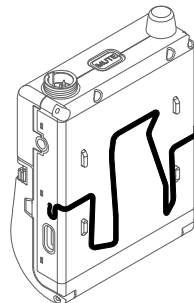

■ Remote Mute Control Function

The device features a 3.5 mm remote mute control socket. Connect the MJ-70 control cable (optional) to operate the mute function remotely.

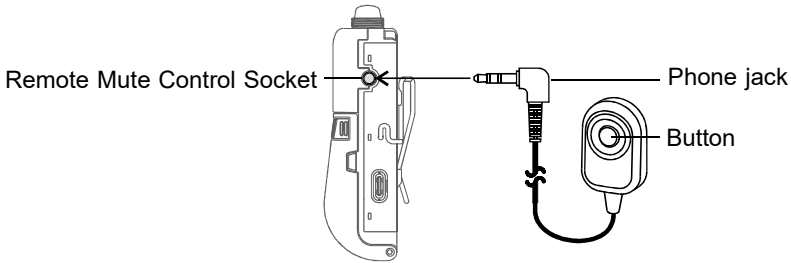

■ SD Memory Card

- **Memory Card Selection:** Please use a high-speed Micro SDHC memory card (FAT32 format) and ensure at least 250MB of free space. If the available space is insufficient, the system may automatically stop recording. If there is no available space, please format the card before use.
- **Inserting and Removing the Memory Card:** Before powering on, insert the memory card with the label side facing down into the slot until it clicks into place. After powering off, press the memory card again to release it, then remove it.
- **Recording Format:** .wav, mono, 24-bit/144kbps.

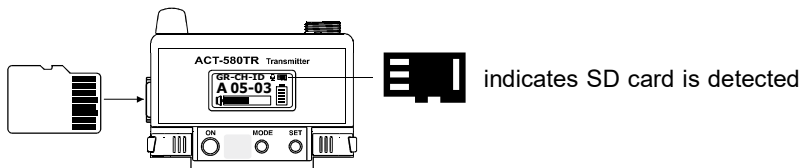

LCD Screen Settings

LCD Screen Display

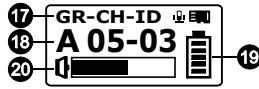

- 17 Functions
- 18 Parameter
- 19 Battery Level
- 20 Audio Signal Level Bar

Battery Level Display

- The LCD screen shows the battery level, divided into six stages: 100%, 80%, 60%, 40%, 20%, and 10%.

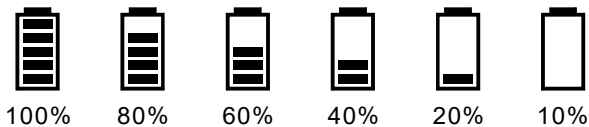

- When the battery level drops to 10%, please recharge immediately. If the voltage becomes too low, the LCD screen will display "OFF..." and the device will shut down automatically.

LCD Screen Functions

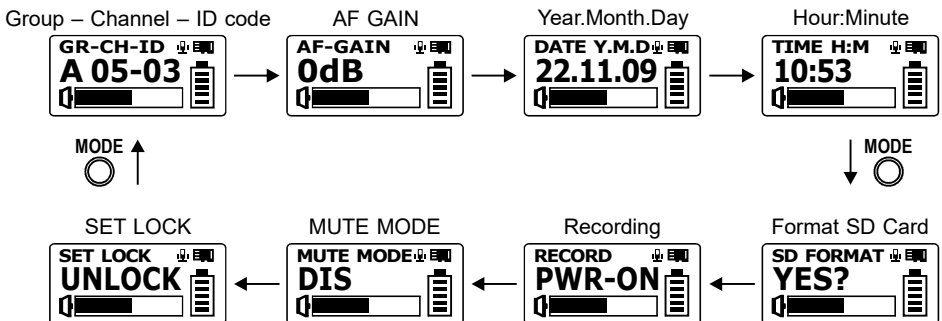

- **Main Screen**

Group – Channel – ID code

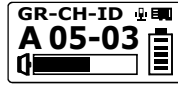

1. Group / Channel / ID Code messages are displayed only and cannot be changed.
2. To change Group / Channel / ID Code, do it at the receiver and then press ACT button to sync.
3. Group settings: A, B1, B2; CH setting: 1-12; ID setting: 1-64 and Pairing mode.

- **AF GAIN**

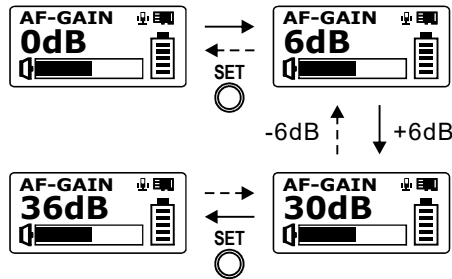

1. AF Gain can be changed from 0 dB to 36 dB, in 6 dB steps. 18 to 24 dB is recommended for using general microphones to pick up.
2. If the AF Gain is set higher, a high input signal will cause distortion and noise floor. When other speakers are working at the same time, it will increase feedback chances.
3. Set AF Gain to 0 dB for electric guitar.
4. 0 dB is the factory default setting.

- **Date Setting**

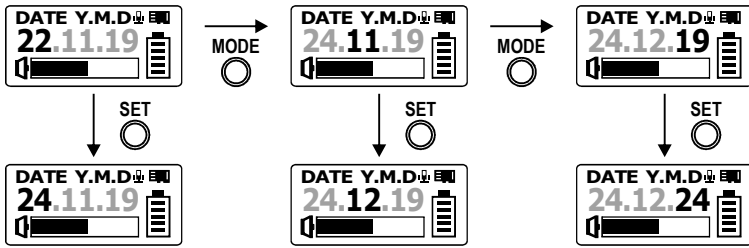

1. Press the SET button. The year will start flashing. Press the SET button to adjust the value (21–99). Press and hold to scroll quickly.
2. Press the MODE button to switch to the month or date. When it starts flashing, press the SET button to adjust. Press and hold for fast cycling.
3. After completing the settings, press the MODE button to save and return to the main screen.

- **Time Setting**

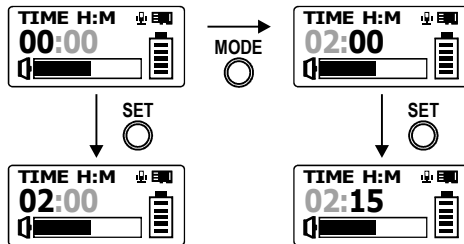

1. Press the SET button. The **Hour** will start flashing. Press the SET button to adjust the value (24-hour format). Press and hold for fast cycling.
2. Press the MODE button to switch to **Minutes**. When it starts flashing, press the SET button to adjust. Press and hold for fast cycling.
3. After completing the settings, press the MODE button to save and return to the main screen.

- **Format SD Card**

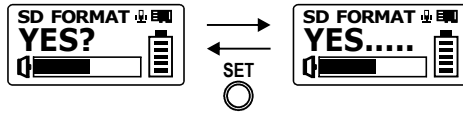

1. Press the SET button. The screen will display **"YES?"** and start flashing, prompting for format confirmation.
2. Press the SET button again to confirm. The screen will display **"YES..."**, indicating that formatting is in progress.
3. Once formatting is complete, the screen will return to the standby screen.

- **Recording**

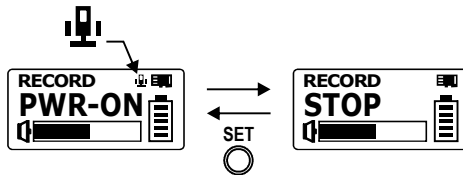

1. The screen displays **"PWR-ON"**, indicating that the recording function is enabled.
2. Press the SET button, and **"PWR-ON"** will start flashing. Press the SET button again, and the screen will display **"STOP"**, indicating that the recording function is disabled and returning to the main screen.
3. The factory default setting has the recording function enabled.
4. When the transmitter is powered on and detects an SD card, the device will start recording automatically.

• **MUTE MODE**

- Two modes are available: Manual (**MAN**) or Disabled (**DIS**).

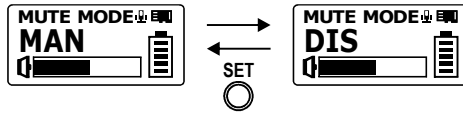

- Press the SET button to switch to **DIS** mode, which disables the mute button, making it non-functional.
- The factory default is **MAN** mode:
 - Press the mute button to enter mute mode; the screen will display "**AF MUTE**" and flash.
 - Press the mute button again to unmute.
 - The mute function is automatically disabled when the device is powered off.
 - The recording function is not affected by the mute button.

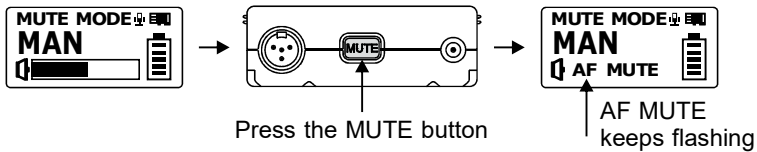

• **SET LOCK**

- Two modes are available: Unlock (**UNLOCK**) or Lock (**LOCK**).
- LOCK** Mode:
 - All function settings, including the power switch, cannot be changed.
 - The lock function is automatically disabled when the device is powered off.
- The mute button remains functional in **LOCK** Mode.

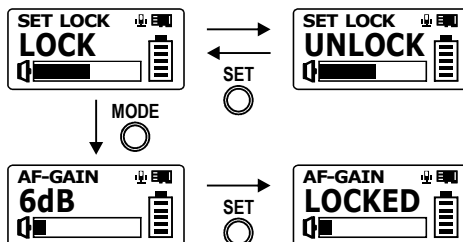

4-Pin Microphone Input Jack Wiring

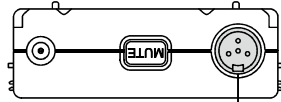

1. 2-wire condenser microphone capsule connection

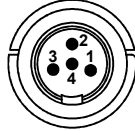
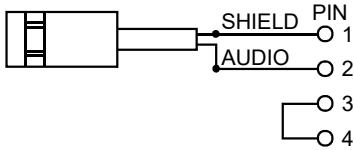

2. 3-wire condenser microphone capsule connection

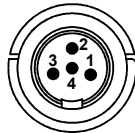
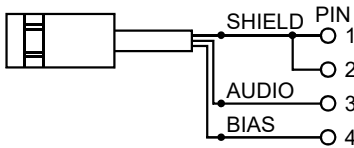

3. Dynamic microphone

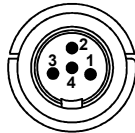
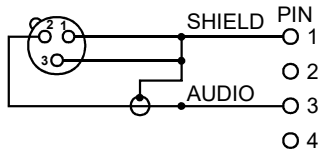

4. Electric guitar

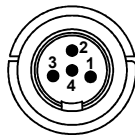
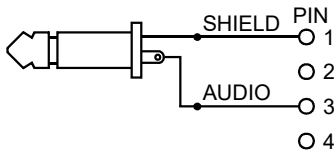

5. Line-in (impedance 8K ATT 10 dB)

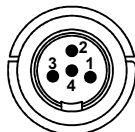
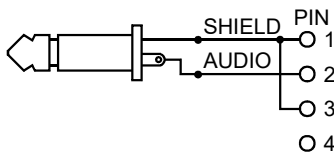

High-frequency Noise Interference

High-frequency noise interference produces continuous high-frequency noise, which deteriorates sound quality. All MIPRO microphone capsule modules have a high-frequency noise interference prevention design. High-frequency noise interference may occur when other brands' microphone capsules are plugged into MIPRO transmitters.

Notes

- In the event of any discrepancy, refer to the **actual product** as the final standard.
- The **carrier frequency range, output power, and maximum deviation** are subject to the **radio regulations** of the respective countries.
- For condenser microphones, it is **strictly prohibited** to spray alcohol directly onto the device for cleaning, as this may cause severe damage and invalidate the warranty.

Federal Communication Commission Interference Statement

This equipment has been tested and found to comply with the limits for a Class B digital device, pursuant to Part 15 of the FCC Rules. These limits are designed to provide reasonable protection against harmful interference in a residential installation.

This equipment generates, uses and can radiate radio frequency energy and, if not installed and used in accordance with the instructions, may cause harmful interference to radio communications. However, there is no guarantee that interference will not occur in a particular installation. If this equipment does cause harmful interference to radio or television reception, which can be determined by turning the equipment off and on, the user is encouraged to try to correct the interference by one of the following measures:

- Reorient or relocate the receiving antenna.
- Increase the separation between the equipment and receiver.
- Connect the equipment into an outlet on a circuit different from that to which the receiver is connected.
- Consult the dealer or an experienced radio/TV technician for help.

FCC Caution: To assure continued compliance, any changes or modifications not expressly approved by the party responsible for compliance could void the user's authority to operate this equipment. (Example - use only shielded interface cables when connecting to computer or peripheral devices).

FCC Radiation Exposure Statement

This equipment complies with FCC RF radiation exposure limits set forth for an uncontrolled environment. This equipment should be installed and operated with a minimum distance of 0.5 centimeters between the radiator and your body.

This transmitter must not be co-located or operating in conjunction with any other antenna or transmitter.

The antennas used for this transmitter must be installed to provide a separation distance of at least 0.5 cm from all persons and must not be co-located or operating in conjunction with any other antenna or transmitter.

This device complies with Part 15 of the FCC Rules. Operation is subject to the following two conditions:

(1) This device may not cause harmful interference, and (2) This device must accept any interference received, including interference that may cause undesired operation.



Dispose of any unusable devices or batteries responsibly and in accordance with any applicable regulations.

Disposing of used batteries with domestic waste is to be avoided!



Batteries / NiCad cells often contain heavy metals such as cadmium(Cd), mercury(Hg) and lead(Pb) that makes them unsuitable for disposal with domestic waste. You may return spent batteries/ accumulators free of charge to recycling centres or anywhere else batteries/accumulators are sold.



By doing so, you contribute to the conservation of our environment!

MIPRO ELECTRONICS CO., LTD.

Headquarters: NO. 814, Beigang Rd., Chiayi City 600079, Taiwan

Tel : +886-5-238-0809

Fax : +886-5-238-0803

www.mipro.com.tw

mipro@mipro.com.tw



2CE683F

All rights reserved. Do not copy or forward without prior approvals of MIPRO.
Specifications and design subject to change without notice. YM 026/03